

Installation Instructions

For

Surface Mounted Signs

Sign Brackets

Architectural Brackets

Suspension Mounted Signs

Step Edge Contrast E Series and N Series

Step Nosing F Series (Two part installation)

Step Nosing F Series

Guidance Strip G Series (Tape)

Guidance Strip G Series (Adhesive)

Handrail Marker H Series

Handrail Wall Strip MS26

Path Marker T Series

Path Marker G7 Solaris

Aisle & Seat Markers

Door Marking Guide

Cleaning Instructions

(For Hybrid Sign Installation Instructions see website)



Installation Instructions For

Surface Mounted Signs

Ecoglo exit signs are to be installed only where there will be sufficient natural or artificial light to keep them charged whenever the building is occupied.

If unsure, contact Ecoglo



Surface Mounted Signs

Mounting Location

- At doors: mount on a vertical surface within 600mm of the door where the sign is least likely to be obscured from view. Where the ceiling is directly above the top of the door, the sign can be mounted on the door as long as the door is outward opening, and has a self-closer mechanism.
- On walls: mount 2 - 2.5 metres above floor level, or where it is least likely to be obscured from view.
- When installing the sign make sure it is parallel to the nearest horizontal building feature, so that it looks level to the eye.



Mounting Surfaces

- Timber: screw install (use all 4 holes in the sign).
- Plasterboard: screw install with suitable anchors (use all 4 holes in the sign).
- Glass: adhere with NZ Tape Spec 1811 high strength white foam back mounting tape. For signs up to 420mm x 230mm apply two strips of tape 200mm x 25mm near the top and bottom of the sign.
- Concrete, Solid plaster, Steel: adhere with Bostik Seal'N'Flex FC or Wurth KD Bond, and use foamback tape eg NZ Tape Spec 1822 to ensure sign stays in position while the adhesive is curing.





Installation Instructions For

Sign Brackets

Flag and Ceiling Mounted Signs

Ecoglo exit signs are to be installed only where there will be sufficient natural or artificial light to keep them charged whenever the building is occupied.

If unsure, contact Ecoglo



Sign Brackets Flag & Ceiling Mounted Signs

1. Assembling the Bracket



- Place a washer on screw and insert into top-left corner of first sign.

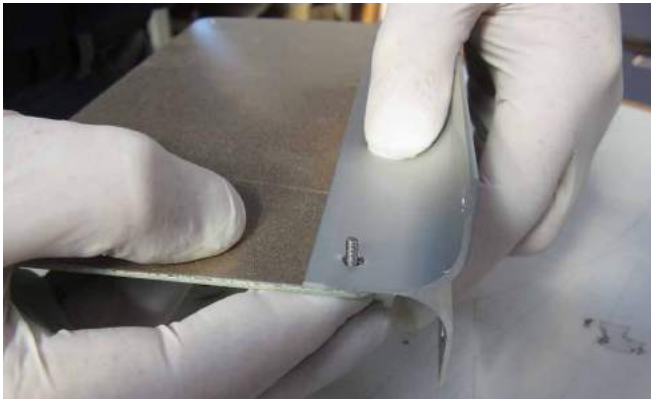

- Place mounting bracket over screw.



- If required, place second sign over screw onto opposing side of bracket. Ensure the signs are facing the correct direction.

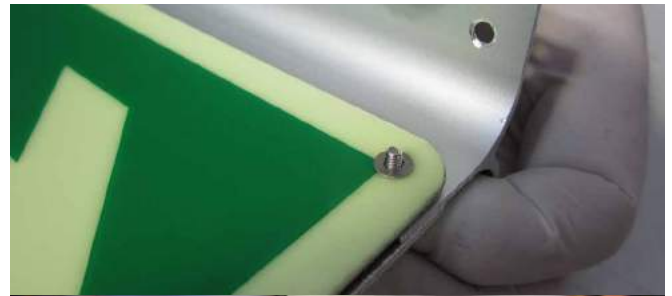

- Place a washer and nut onto screw and tighten with fingers.

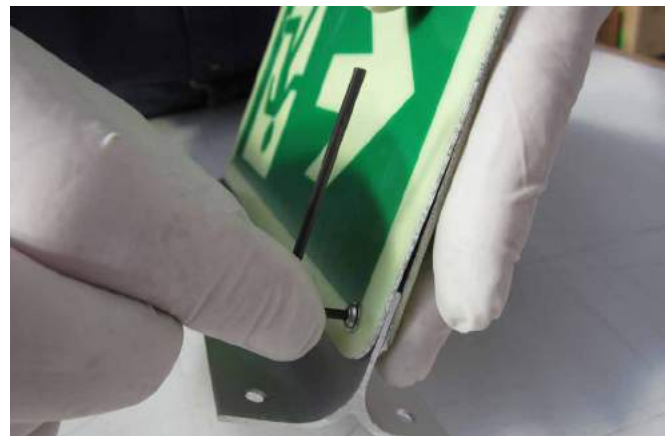

- Using supplied Hex Key and a crescent tighten the nut until flush with surface of sign.



- Repeat previous steps on all corners.

Sign Brackets Flag & Ceiling Mounted Signs

2. Installing the Bracket



- Once mounting location has been decided hold flat to wall or ceiling.
- When installing the sign make sure it looks level to the eye.



- Using screwdriver or battery drill mount sign using screws provided.

Mounting Surfaces

- Mounting surfaces:
- Timber: screw install (use all 4 holes in the bracket).
- Plasterboard, Concrete, Solid plaster: screw install with suitable anchors (use all 4 holes in the bracket).
- Steel: screw or rivet install as appropriate (use all 4 holes in the bracket).



Installation Instructions For

Architectural Series Sign Brackets

Ceiling, Flag and Surface Mount



Architectural Series Ceiling Mount Bracket

1. Finger-tighten finishing screws (2) and nuts (3) into bottom corner holes of sign (1).
2. Prepare installation surface. Ensure surface is free of dirt, debris and residue.
3. If mounting sign directly to a ceiling, mark installation surface to ensure sign is properly aligned and level when mounted. Use mounting plate (11) as a template.
4. Drill hole pattern if necessary. Screw mounting plate (11) to installation surface.
5. Screw both L-Brackets (8) onto finishing plate (10) using the 4 x M4 6mm Pan Head Philips machine screws (9).
6. Screw finishing plate (10) onto mounting plate (11) through the centre of the attached L-Brackets (8) using the 2 x No. 8 32 x 16mm Philips machine screws (6).
7. Screw the 2 threaded pins (7) into the L-Bracket (8). Insert inner sign holes onto threaded pins (7) and secure with T-Screws (5) using the supplied tool (4).

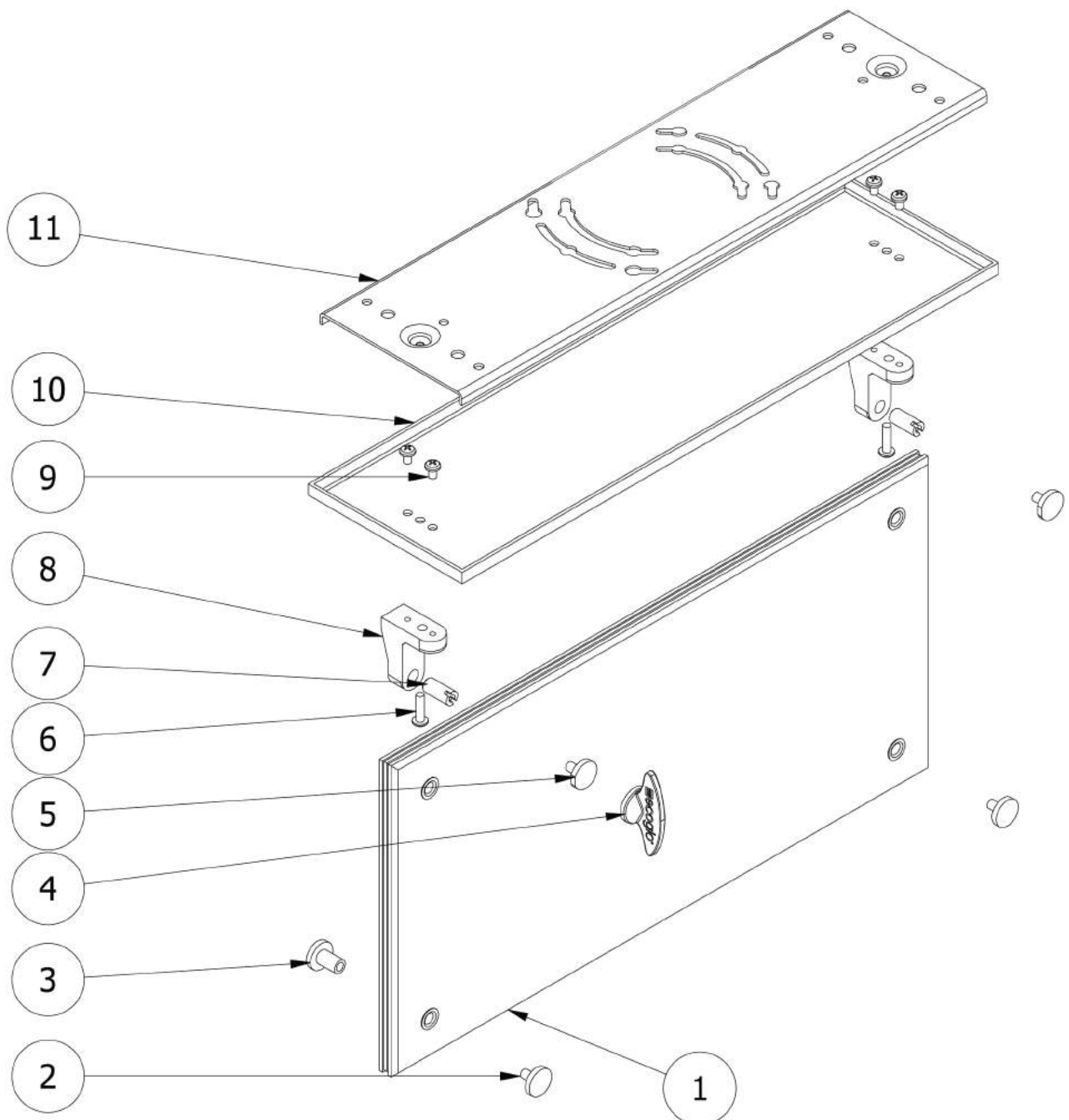

Architectural Series Flag Mount Bracket

1. Finger-tighten finishing screws (2) and nuts (3) into outer corner holes of sign (1).
2. Prepare installation surface. Ensure surface is free of dirt, debris and residue.
3. If mounting sign directly to a wall, mark installation surface to ensure sign is properly aligned and level when mounted. Use mounting plate (11) as a template.
4. Drill hole pattern if necessary. Screw mounting plate (11) to installation surface.
5. Screw both L-Brackets (4) onto finishing plate (9) using the 4 x M4 6mm Pan Head Philips machine screws (10).
6. Screw finishing plate (9) onto mounting plate (11) through the centre of the attached L-Brackets (4) using the 2 x No.8 32 x 16mm Philips machine screws (5).
7. Screw the 2 threaded pins (6) into the L-Bracket (4). Insert inner sign holes onto threaded pins (6) and secure with T-Screws (7) using the supplied tool (8).

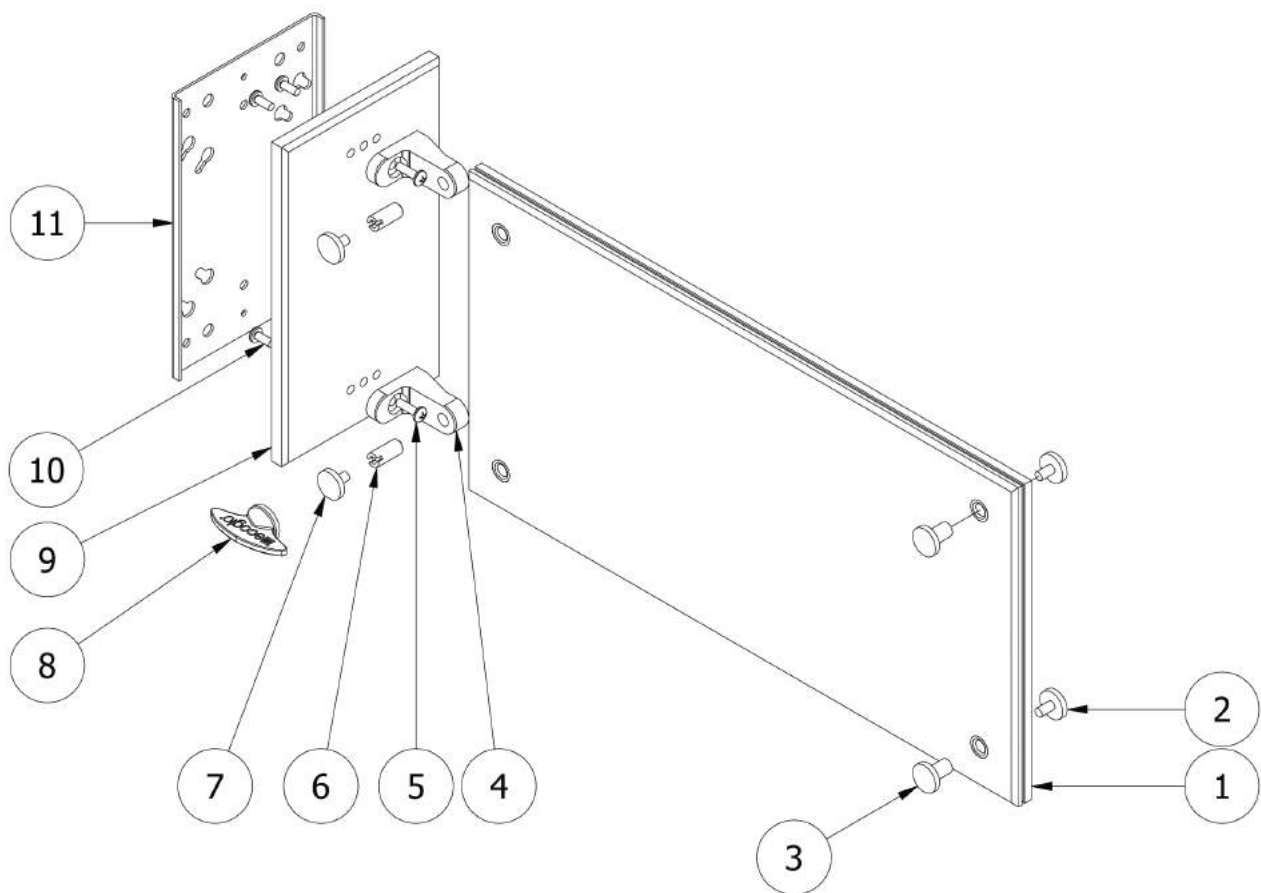

Architectural Series Surface Mount

1. Prepare installation surface. Ensure surface is free of dirt, debris and residue.
2. Mark wall surface to ensure sign (1) is properly aligned and level when mounted.
3. Drill hole pattern. Use a 6mm masonry bit for concrete anchors, 9mm bit for drywall Kwik Tog anchors.
4. Insert mounting sleeves (3) into corner holes of sign, fastening to spacers (2) on other side of sign.
5. Screw sign into wall using the 4 x No. 8 60mm screws (4).
6. Apply provided screw caps (5) to each corner.

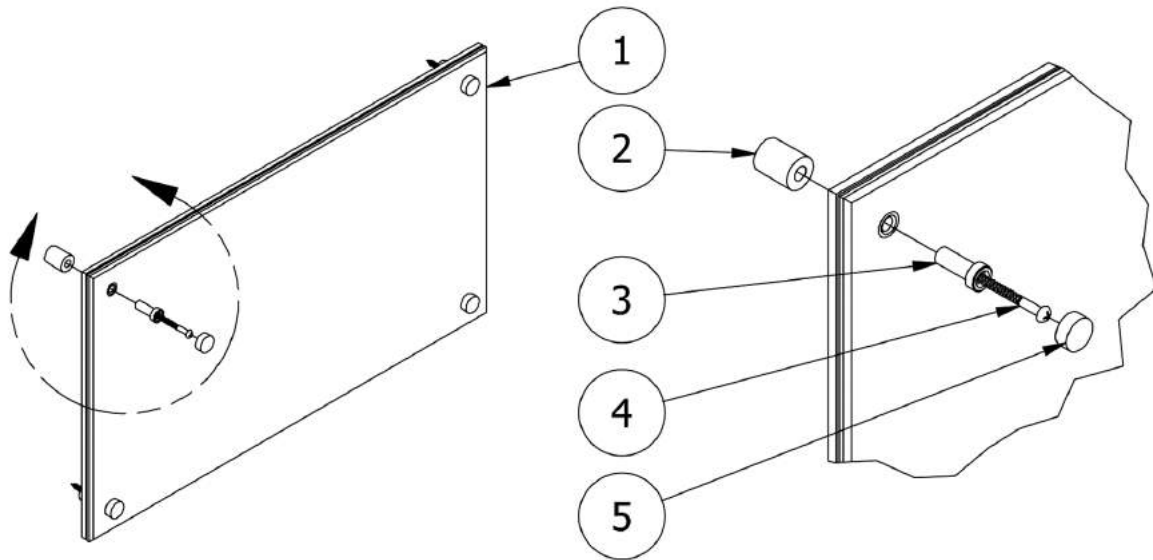

 **ecoglo**[®]
VISIBLY BETTER

Ecoglo International Limited
77 Kingsley Street, Sydenham 8023
PO Box 7698, Sydenham 8240,
Christchurch, New Zealand
Phone: 03 348 3781 Fax: 03 343 6821
Email: info@ecoglo.com Web: www.ecoglo.co.nz



Installation Instructions For

Signs

Suspension Mounted Signs

Ecoglo exit signs are to be installed only where there will be sufficient natural or artificial light to keep them charged whenever the building is occupied.

If unsure, contact Ecoglo



Signs Suspension Mountined Signs



Mounting Location

- When installing the sign make sure it is parallel to the nearest horizontal building feature, so that it looks level to the eye.

Mounting Surfaces

- Use chain or wire from suitable anchor points on the building. Attach to the top 2 holes in the Ecoglo sign with key rings or D-shackles.
- If installed in locations where the sign may be blown around, attach 2 wires or chains to each of the top 2 holes in the Ecoglo sign. The wires or chains should be hung at an angle, for example from 4 points that mark out a 1 metre square.





Installation Instructions For

Step Edge Contrast E Series and N Series

Concrete and Timber



Step Edge Contrast - E Series and N Series Concrete and Timber

1. Preparation of Surface

- Thoroughly clean the surface with industrial strength cleaner if necessary.
- Remove any loose paint or sealant and then allow surface to dry.
- If painted or coated, check that adhesive is compatible with the paint or seal coating*. IF IN DOUBT REMOVE COATING.



Note: Installation onto Concrete Surfaces

- It is important to use adhesive only for concrete installations. The adhesive will allow some movement to compensate for thermal contraction and expansion and will provide durable adhesion to the concrete substrate.

** Where adhesive only installation is preferred on surfaces that have a sealer applied (eg exposed aggregate and some tiles) a test patch should be laid and allowed to temperature cycle over a minimum of 14 days to ensure a good bond is achieved.*

If the adhesive does not hold then mechanical fixers should be used.

If mechanical fixing is not practical due to potential damage to the substrate please contact Ecoglo.

2. Alignment of the Strips

- Mark 50mm from the left edge of the top step.
- Mark 50mm from the left edge of the bottom step.
- Place a string line between the marks to ensure the strip on each step will be correctly aligned.



- The maximum recommended length for installation in outdoor situations is 1.5 metres.
- There must be a 3mm gap between lengths. This allows for thermal expansion in extreme weather conditions and also aids in water drainage off the step tread.
- Leave a 3mm gap either side of built-in steps

3. Preparation of the Strip

- Clean back of contrast strip with soft cloth and if necessary use methylated spirits (or similar solvent) to remove oil or grease
- Allow to dry for approximately 1 minute.

4. Applying the Adhesive

- Apply a 3mm zigzag bead of polyurethane adhesive (such as Wurth KD Bond and Seal or Bostik Seal n Flex FC) to the back of the strip, 3mm in from the edges.
- Continue along the length of the strip.



Adhesive Usage:

E2/N2 Series - 30 metres per 600ml

E3/E4/N3 Series - 25 metres per 600ml

E14/E15/N15 Series - 22 metres per 600ml

Ecoglo can supply Wurth KD Bond and Seal in 600ml Sausage form with Applicator Gun.

5. Placement of the Strip

- Line up the strip with your alignment marks and position approximately 2-3mm back from the front straight edge of the step.
- Place in position with the photoluminescent (light green) component of the strip to the leading edge of the step (see image below).

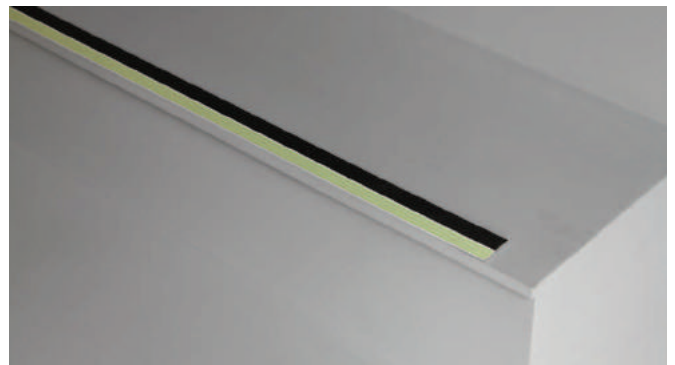

Steps with exposed sides:

Ensure the nosing is set back from exposed side by at least 20mm to ensure the outer edge of the nosing does not present a sharp hazard.

Tile Steps

If the tiles are not perfectly aligned then the contrast strip must be cut into pieces the width of each tile and placed so that the grout line is exposed.

Step Edge Contrast - E Series and N Series Concrete and Timber

6. Apply Pressure to the Strip

- Apply even pressure to spread the adhesive beneath the strip using a hand roller.
- If necessary stand on each strip to ensure good contact between the strip and the step.



7. Allow the Adhesive to Cure

- Immediately following installation close off the area for a period of 8 hours to avoid the Ecoglo strip being moved whilst the adhesive is in the early stages of "cure".
- Wait until adhesive has fully cured (allow at least 24 hours) before trimming any excess from each strip with a sharp blade.

8. Use of Fixers (for Outdoor Timber installations only)

Note: Indoor installations only require adhesive

Outdoor Timber becomes a two step process

For outdoor timber installations both adhesive and fixers should be used because installation onto outdoor timber surfaces varies due to the uneven nature of timber, the various types of timber (eg pine or kwila), the protective coating (eg paint or sealer) and seasonal temperature variances.

Step 1:

- Apply adhesive as per steps 3-4 taking care to keep adhesive away from pre drilled holes.
- Place strip as per steps 5-6.
- Leave the adhesive to cure for 7 days before installing the fixers.

Step 2:

- Place a screw fixer into each hole and drill in securely using a battery drill.
- Do not fully tighten the fixers to avoid compressing the adhesive.

For timber installations the strips should be pre-drilled through the anti-slip material. The table below shows the number of drill holes required to allow for the natural contraction and expansion of timber.



Hole Drilling Specifications

Hole Drilling Specification	Less than 350mm	350mm - 650mm	650mm - 950mm	950mm - 1250mm	1250mm - 1500mm
Number of Holes	2	3	4	5	6

Holes for fixers are usually drilled as part of manufacturing. If for any reason the product was ordered, or supplied, without holes where fixers are required then Ecoglo recommend the hole spacings shown in the table above for maximum durability.



Installation Instructions For

Step Nosing F Series

Two-Part Installation
Concrete and Timber



Step Nosing - F Series Two-Part Installation Concrete and Timber

1. Preparation of Surface

- Brush the surface clean of dust and debris. If necessary, clean with an industrial cleaner.
- Remove any paint or sealant and then allow the surface to dry.
- It is better for adhesion if timber surfaces are dry.



Steps with exposed sides:

Ensure the nosing is set back from exposed side by at least 20mm to ensure the outer edge of the nosing does not present a sharp hazard.

Built-in steps, Installed outdoors:

Leave a 3mm gap between the nosing and the built-in sides, to allow for thermal expansion, and water drainage.

NOTE: The maximum recommended length for installation in outdoor situations is 1.5 metres. A 3mm expansion / drainage gap must be left between lengths.

2. Alignment (for installation onto more than one step)

- Place one piece of step nosing on the top step and one on the bottom step.
- Run a string line from the left edge of the top nosing to the left edge of the bottom nosing.
- This will give you a straight, true line.



3. Locating Holes for Fixers (for Timber skip to step 5)

- Place the nosing firmly against the riser of the step.
- Line it up with your string line.
- Mark the location of the drill holes with the drill.
- Remove the nosing.

NOTE: The F14-175 nosing comes pre-drilled with holes every 100mm. You only require 4 fixers per metre. Fixers should be zig-zagged across the pre-drilled holes to give maximum support to both sides of the nosing.

4. Drilling holes for fixers (for Timber skip to step 5)

- Using a 6mm masonry bit, and a concrete drill, drill the hole that will house the plastic anchor.
- Wipe away any dust or debris.
- Place the plastic anchor fully in to the holes.



5. Applying Adhesive

- Lay a 3mm bead of polyurethane adhesive (such as Wurth KD Bond and Seal or Bostik Seal n Flex FC) in a wave pattern over the full length of the underside of the nosing.
- Keep the adhesive clear of the outside edge and the drill holes.



Step Nosing - F Series Two-Part Installation Concrete and Timber

6. Securing the nosing profile

- Place the nosing firmly back onto the step, lining up the drill holes.
- Tighten the screws firmly using a battery hand drill- this will create a strong, even bond.
- For fixing on to wooden substrate follow the previous instructions but the plugs are not required.

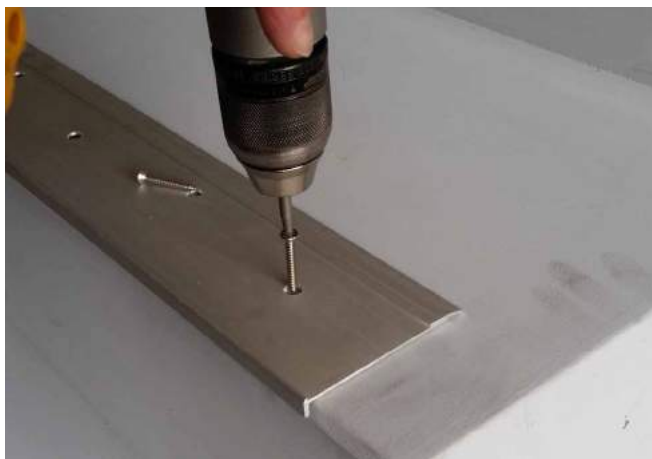

Adhesive Usage:

11 metres per 600ml sausage

Ecoglo supply screw fixers with all orders and can also supply Wurth KD Bond and Seal in 600ml Sausage form with Applicator Gun.

7. Fixing Insert Strip

- Check nosing extrusion channel is free from dust, dirt, grease and moisture.
- Dust or wipe with methylated spirits or damp cloth if required.
- Lay a zigzag of adhesive, 1mm deep, 3mm wide on to the strip.
- Ensure that you don't over apply adhesive as it will spill out once the insert is placed into the nosing.



8. Insert strip into the nosing

- Line up the strip insert then place firmly onto the nosing.
- Press in place to ensure even contact, between the adhesive, and the surface of the channel.
- Use a roller or your foot to apply firm downward pressure.
- Use an alcohol wipe to remove any spill over of adhesive.

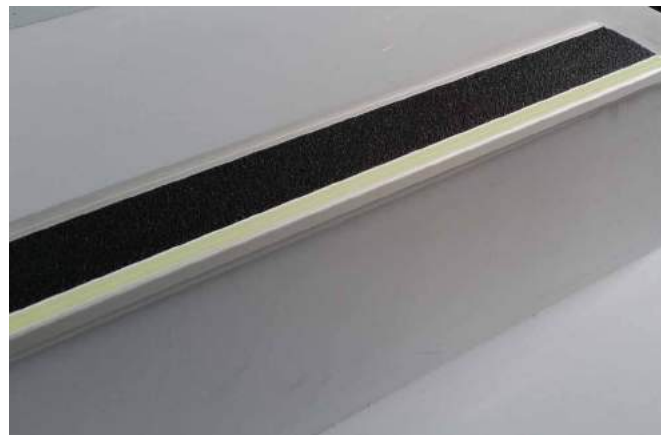

9. Curing of Adhesive

- Allow approximately 24 hours for adhesive to cure.

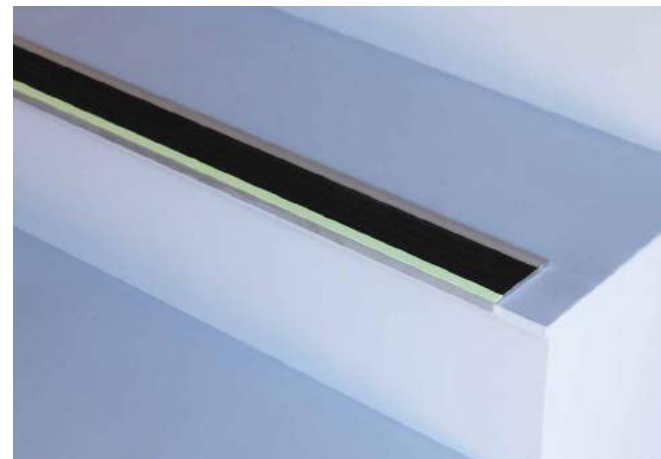

Installation Instructions For

Step Nosing F Series

Concrete and Timber



Step Nosing - F Series Concrete and Timber

1. Preparation of Surface

- Brush the surface clean of dust and debris. If necessary, clean with an industrial cleaner.
- Remove any paint or sealant and then allow the surface to dry.
- It is better for adhesion if timber surfaces are dry.



Steps with exposed sides:

Ensure the nosing is set back from exposed side by at least 20mm to ensure the outer edge of the nosing does not present a sharp hazard.

2. Alignment (for installation onto more than one step)

- Place one piece of step nosing on the top step and one on the bottom step.
- Run a string line from the left edge of the top nosing to the left edge of the bottom nosing.
- This will give you a straight, true line.



Built-in steps, Installed outdoors:

Leave a 3mm gap between the nosing and the built-in sides, to allow for thermal expansion, and water drainage.

NOTE: The maximum recommended length for installation in outdoor situations is 1.5 metres. A 3mm expansion / drainage gap must be left between lengths.

3. Locating Holes for Fixers (for Timber skip to step 5)

- Place the nosing firmly against the riser of the step.
- Line it up with your string line.
- Mark the location of the drill holes with the drill.
- Remove the nosing.



4. Drilling holes for fixers (for Timber skip to step 5)

- Using a 6mm masonry bit, and a concrete drill, drill the hole that will house the plastic anchor.
- Wipe away any dust or debris.
- Place the plastic anchor fully in to the holes.



Step Nosing - F Series Concrete and Timber

5. Applying Adhesive

- Lay a 3mm bead of polyurethane adhesive (such as Wurth KD Bond and Seal or Bostik Seal n Flex FC) in a wave pattern over the full length of the underside of the nosing.
- Keep the adhesive clear of the outside edge and the drill holes.



Adhesive Usage:

22 metres per 600ml sausage

Ecoglo supply screw fixers with all orders and can also supply Wurth KD Bond and Seal in 600ml Sausage form with Applicator Gun.

6. Fixing the Nosing

- Place the nosing firmly back onto the step, lining up the drill holes.
- Tighten the screws firmly using a battery hand drill- this will create a strong, even bond.
- For fixing on to wooden substrate follow the previous instructions but the plugs are not required.



7. Curing of Adhesive

- Use an alcohol wipe to remove any spill over of adhesive. Allow approximately 24 hours for adhesive to cure.

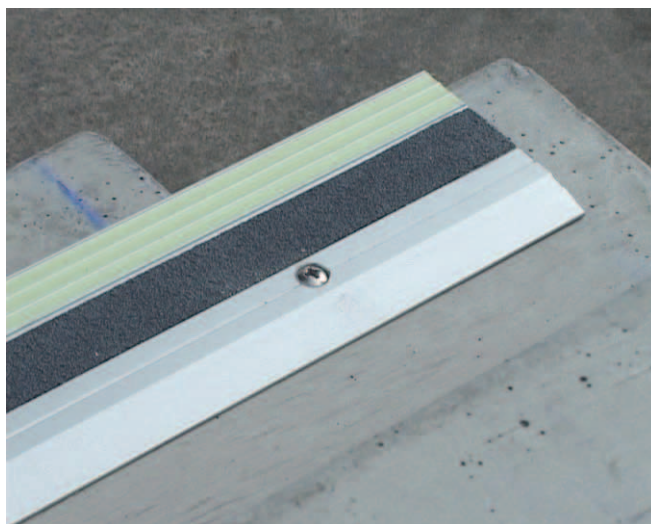



Installation Instructions For

Guidance Strips G Series (Tape)

Flat Surfaces



Guidance Strips - G Series Flat Surfaces

Ecoglo G-Series guidance strips are extremely versatile and can be applied on various types of surface, including walls, skirting board, floors, door frames and flat sided handrails. Generally, as long as the substrate is clean, flat and dry the product can be successfully installed.

Ecoglo G-Series guidance strips have a self-adhesive backing with a release tape for simple installation. (See Section 4 of these instructions if in any doubt about adhesion).

1. Preparation of Surface

- Thoroughly clean the surface with an industrial strength cleaner if necessary.
- Remove any loose paint or sealant and then allow the surface to dry.
- If the surface has been painted or coated, check that adhesive is compatible with the paint or seal coating.
IF IN DOUBT REMOVE COATING.
- The tape is suitable for a temperature range of 0-40C.
- Maximum installation length is 1500mm.

2. Positioning, Alignment of the Strips

- If installing on a flat handrail or other surface such as a wall, mark the position where the strip is to be placed. Use a chalkline, plumb-line or spirit level if necessary to ensure the line is straight.
- Offer up the strip to the surface it is to be attached to, to make sure both surfaces are parallel. If the strip does not sit perfectly flat against the surface without being held in place, carefully bend the strip until it sits perfectly flat against the surface.

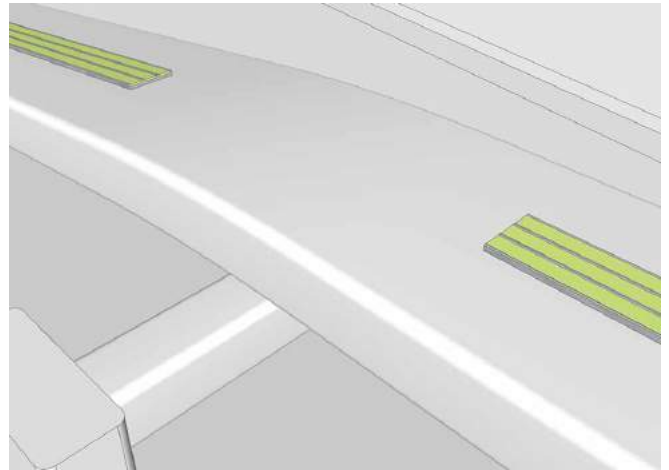
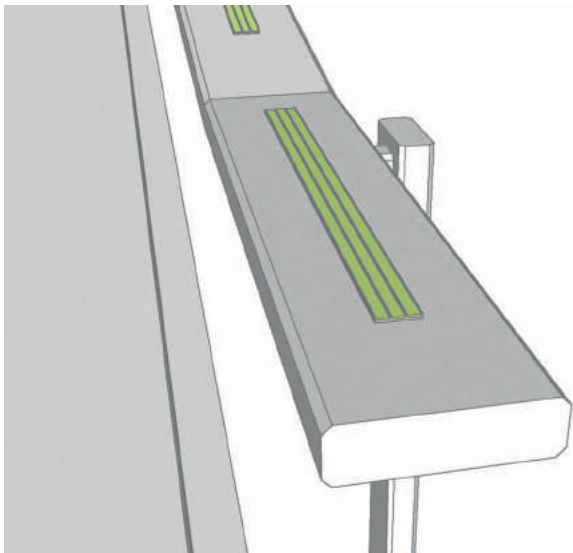

Do not bend guidance strips over bends. Set the strip 50mm from the bend.

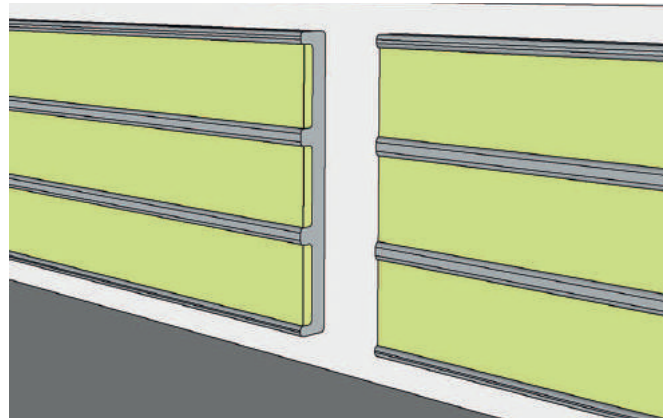

Where strips are to be butted together, there must always be a 3mm expansion gap between them. This allows for expansion and contraction between the Ecoglo strip and the building surface.

3. Placement of Adhesive-backed Strip

- Carefully peel off the release-tape backing from the strip.
- Carefully line the strip up with any alignment marks.
- Press the strip firmly in place to ensure even contact between the adhesive tape and the surface to which it is being applied.

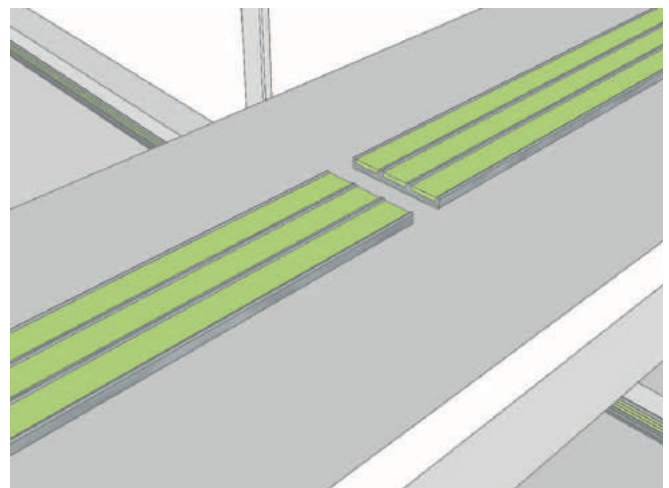

Guidance Strips - G Series Flat Surfaces

Guidance strip can be used to mark corridors, lobbies and indoor lengths of path and can be mounted either on the floor within 100mm of the wall, or on the wall within 100mm of the floor. Gaps of 3mm must be placed between strips.

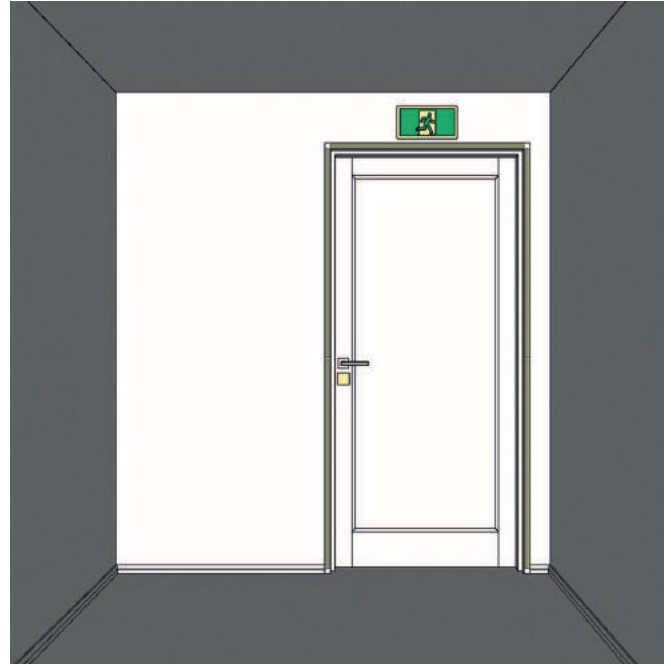
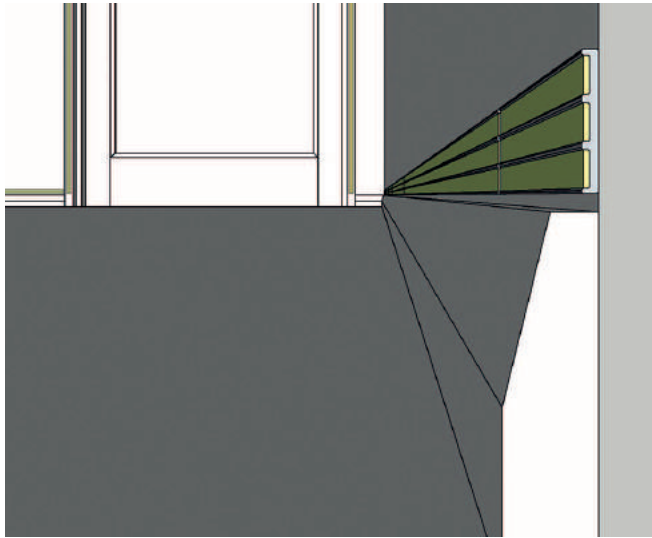

4. Mechanical Fixers (Screws or Rivets)

- Where the strip is used to mark handrails, indoors and outdoors, screws (for timber) or rivets (for metal) **MUST** also be used. Install one screw/rivet 10-15mm in from each end of each strip.
- For outdoor timber installations screws **MUST** also be used so that the adhesive tape isn't able to lift if the timber distorts or absorbs moisture due to normal weather conditions. 5mm pan head screws are suitable to be screwed down firmly but not so tight that the tape squashes under the strip. Install one screw 10-15mm in from each end and one screw in the middle of each strip.
- If in doubt about the adhesion of the strips to any substrate, use screws/rivets for additional security. Install one 10-15mm in from each end and one in the middle of each strip.

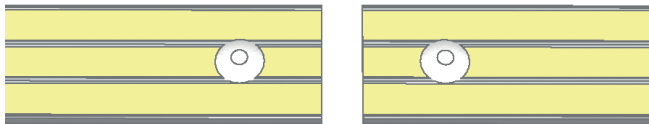

For guidance strips on handrails used in schools or public places, screws or rivets must be installed 10 – 15mm in from the end of each strip.



Installation Instructions For

Guidance Strips G Series (Adhesive)

Flat Surfaces



Guidance Strips - G Series Flat Surfaces

Ecoglo G-Series guidance strips are extremely versatile and can be applied on various types of surface, including walls, skirting board, floors, door frames and flat sided handrails. Generally, as long as the substrate is clean, flat and dry the product can be successfully installed.

(If installing on handrails, or if in doubt about adhesion, see Section 8 of these instructions.)

1. Preparation of Surface

- Thoroughly clean the surface with an industrial strength cleaner if necessary.
- Remove any loose paint or sealant and then allow the surface to dry.
- If the surface has been painted or coated, check that adhesive is compatible with the paint or seal coating.
IF IN DOUBT REMOVE COATING.
- Maximum installation length is 1500mm.

2. Positioning, Alignment of the Strips

- If installing on a flat handrail or other surface such as a wall, mark the position where the strip is to be placed. Use a chalkline, plumb-line or spirit level if necessary to ensure the line is straight.
- Offer up the strip to the surface it is to be attached to, to make sure both surfaces are parallel. If the strip does not sit perfectly flat against the surface without being held in place, carefully bend the strip until it sits perfectly flat against the surface.

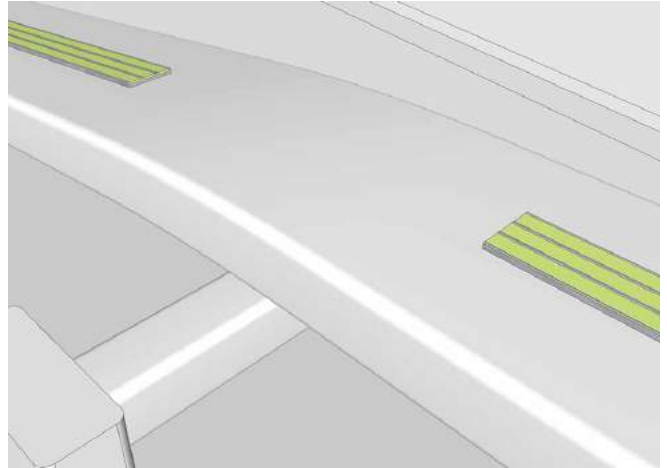
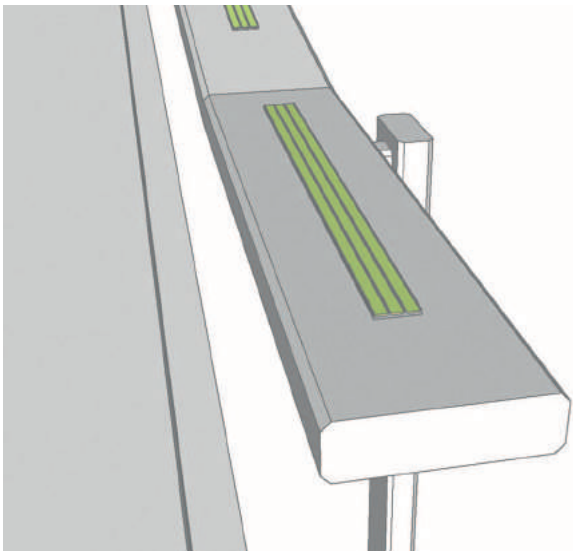

Do not bend guidance strips over bends. Set the strip 50mm from the bend.

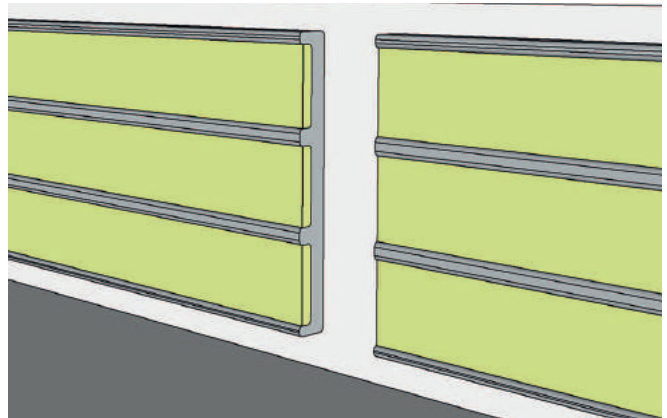

Where strips are to be butted together, there must always be a 3mm expansion gap between them. This allows for expansion and contraction between the Ecoglo strip and the building surface.

3. Preparation of the Strip

- Clean back of the strip with a soft cloth and if necessary use methylated spirits or similar solvent to remove oil or grease.
- Allow to dry for approximately 1 minute.

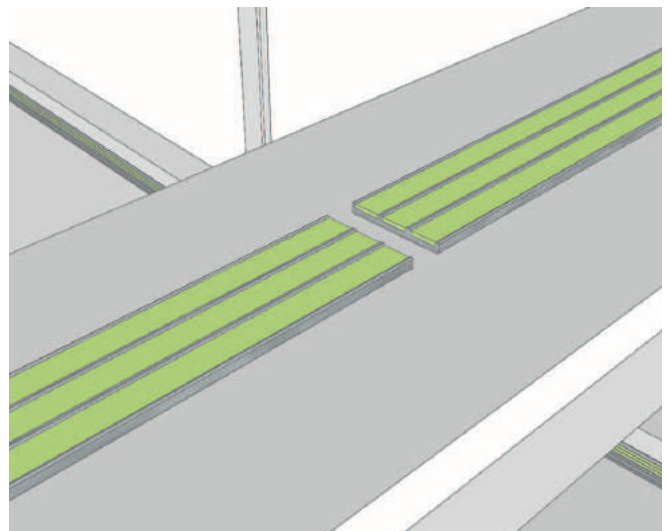

Guidance Strips - G Series Flat Surfaces

Guidance strip can be used to mark corridors, lobbies and indoor lengths of path and can be mounted either on the floor within 100mm of the wall, or on the wall within 100mm of the floor. Gaps of 3mm must be placed between strips.

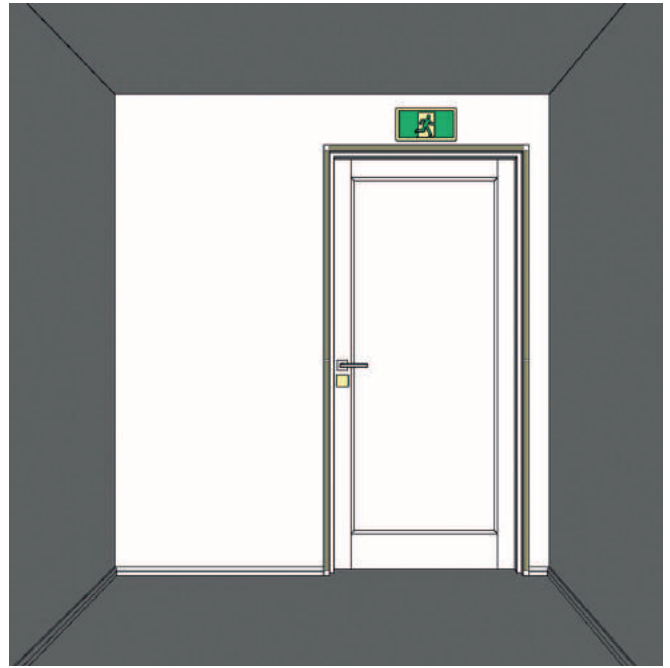
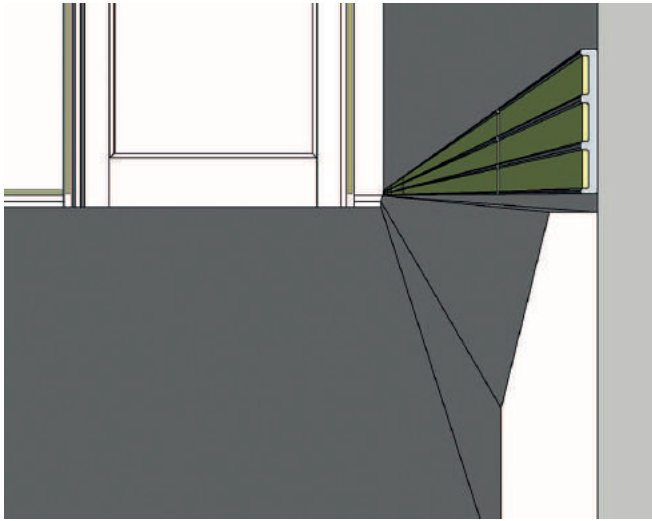

4. Applying the Adhesive

- Apply a 3mm bead of polyurethane adhesive (such as Wurth KD Bond and Seal or Bostik Seal'n'Flex FC) in a wave pattern along the full length of the back of the strip, keeping 3mm in from the edges.

Adhesive Usage: 80 metres per 600ml.

Ecoglo can supply Wurth KD Bond and Seal in 600ml Sausage form with Applicator Gun.

5. Placement of the Strip

- Line up the strip with your alignment marks. Press the strip firmly in place to ensure even contact between the strip and the surface to which it is being applied.

6. Apply Pressure to the Strip

- Apply even pressure to spread the adhesive beneath the strip using a hand roller.

7. Curing of Adhesive

- Use an alcohol wipe to remove any spillover adhesive. Allow approximately 24 hours for adhesive to cure.

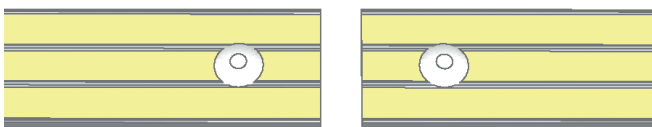

For guidance strips on handrails used in schools or public places, screws or rivets must be installed 10 – 15mm in from the end of each strip.

8. Mechanical Fixers (Screws or Rivets)

- Where the strip is used to mark handrails, indoors and outdoors, screws (for timber) or rivets (for metal) MUST also be used. Install one screw/rivet 10-15mm in from each end of each strip.
- For outdoor timber installations screws MUST also be used so that the strip isn't able to lift if the timber distorts or absorbs moisture due to normal weather conditions. 5mm pan head screws are suitable to be screwed down firmly. Install one screw 10-15mm in from each end and one screw in the middle of each strip.
- If in doubt about the adhesion of the strips to any substrate, use screws/rivets for additional security. Install one 10-15mm in from each end and one in the middle of each strip.

Installation Instructions For

Handrail Marker H Series

Wall Mounted and Freestanding
Round Handrails

Ecoglo Australia
Email: info@ecoglo.com
Ph: +61 3 8691 5288
www.ecoglo.com.au

Ecoglo New Zealand
Email: info@ecoglo.com
Ph: +64 3 348 3781
www.ecoglo.co.nz



Handrail Marker - H Series

Round Handrails

1. Preparation of Surface

- Thoroughly clean the surface with an industrial strength cleaner.
- Remove any loose paint or sealant and then allow the surface to dry.
- Handrail must be dry.



2. Alignment

- To ensure the Ecoglo Handrail Strip is installed in line, place a string line, slightly off centre, from the top end of the handrail to the bottom.
- This will serve as a guide for where to place each strip accurately onto the rail.



3. Placing Strip onto Handrail

- Remove the backing paper from the tape.
- Line up the outside edge with the string line. The strip should be positioned approximately 50mm from the end of the handrail.
- Press firmly down.
- Repeat the above steps for the full length of the handrail leaving a 5mm gap between each length of handrail strip.

Where strips are to be butted together, there must always be a 5mm expansion gap between them. This allows for expansion and contraction between the Ecoglo strip and the handrail surface and also aids in water drainage off the handrail.

- If the overall length of the handrail is longer than 1 metre as supplied, then the 1 metre lengths should be placed at each end of the handrail and a separate unit should be measured and cut for the middle section.



4. Bends and Curves on Handrails

- Under no circumstances should handrail product be installed on or around a curve. This includes bends at each end of the handrail.
- Set the strip 50mm from a bend or a curve.

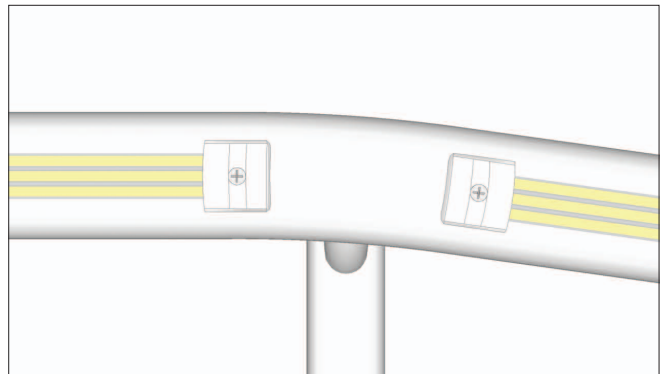

Handrail Marker - H Series Round Handrails

5. Placement of Joiner Caps

- Where a small gap (minimum of 5mm) has been left between lengths, Ecoglo recommends placing an Ecoglo HRJ3 Joiner Cap. This ensures no sharp edges are exposed while protecting the ends of the strips.
- The joiner cap is placed over both ends of each strip and secured with a screw (on timber handrails) or a rivet (on metal handrails).

If no joiner caps are used, ensure edges are filed smooth and rounded following any cutting of the strip.

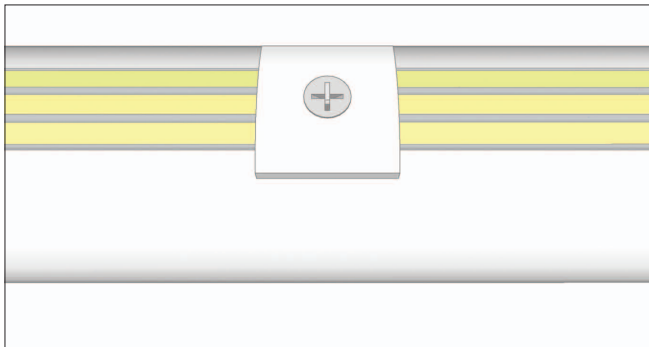
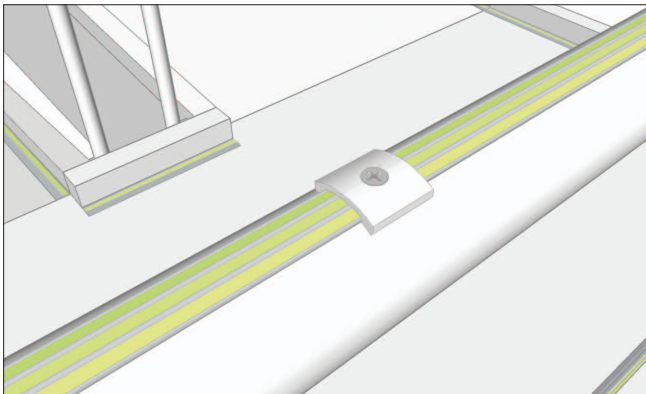

6. Placement of End Caps

- Ecoglo recommends placing an Ecoglo HREC3 End Cap on each end of handrail strip. This ensures no sharp edges are exposed while also protecting the end of the strip.
- The end cap is placed over the end of the strip and secured with a screw (on timber handrails) or a rivet (on metal handrails).

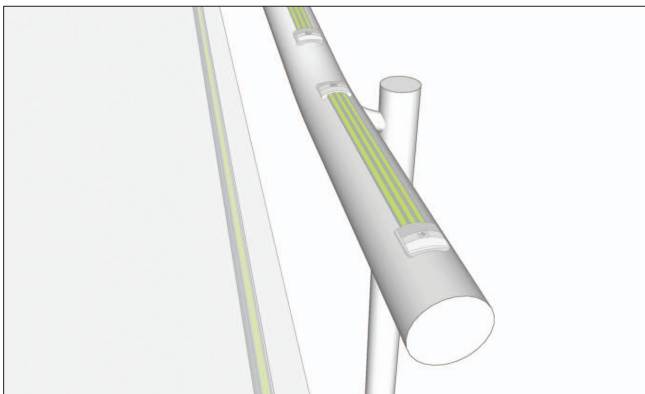

If no end caps are used, ensure edges are filed smooth and rounded following any cutting of the strip.

Rivets: (RIV3.2/10 - 3.2x10 Sealed Blind Rivets in White) included with Joiner Caps and End Caps

Screws: STCQX419WHT - 4Gx19 Countersunk Square Drive Self Tapper in White

7. Mechanical Fixers (screws or rivets)

- If the installer has elected not to use end or joiner caps, mechanical fixers are still required.
- To ensure water tightness, Ecoglo recommends the use of sealed rivets where fixers are used on metal handrails.
- In all installations, indoor and outdoor, screws (for timber) or rivets (for metal) MUST also be used. Install one screw/rivet 10-15mm in from each end of each H series strip.
- For outdoor timber installations 5mm pan head screws are suitable. Screw down firmly but not so tight that the tape squashes under the strip. Install one screw 10-15mm in from each end and one screw in the middle of each H series strip.

Note: Flat Handrails

- Ecoglo G3-001 can be used on indoor handrails that have flat tops. The same method of installation applies. There are no End Caps or Joiner Caps available for flat handrails.





Installation Instructions For

Handrail Wall Strip MS26

Wall Mounted Handrails



Handrail Wall Strip - MS26 Wall Mounted Handrails

1. Preparing the Wall Surface

- Thoroughly clean the wall surface, if necessary use an industrial strength cleaner.
- Remove any loose paint or sealant and then allow the surface to dry.
- Wall must be clean and dry for adhesive tape to adhere.

2. Alignment

- Using a pencil, mark a line along the wall parallel to the handrail.
- This will be used as a guideline to position the MS26 in line with the handrail.

Note: The MS26 strip must be installed within **100mm horizontally** and **50mm vertically up** from the **centre** of the handrail.

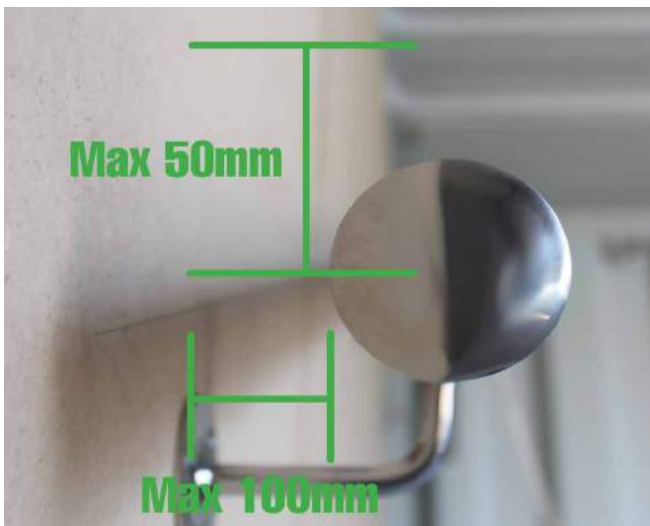

3. Placing the MS26 Strip

- Peel the first 50mm of backing tape back.
- Place the end of the MS26 strip on the wall in the line with your pencil mark.
- Once the full length of the piece is lined up with the guideline pull the remaining backing off the tape and push the MS26 strip firmly onto the wall as you do so.

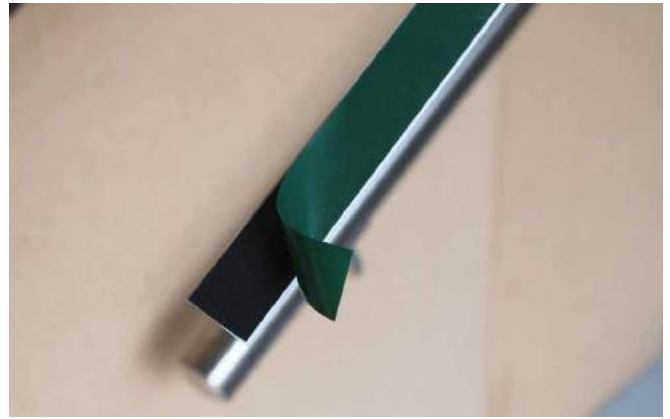

Before removing the backing tape, make sure each piece of MS26 is straight and will sit flat against the wall without any need to hold it flat. If it doesn't sit flat, carefully bend it until it does.



Note: A maximum gap of 100mm is acceptable between pieces and bends in the handrail. ie pieces don't need to be hard up against each other.



Installation Instructions For

Path Marker T Series

Concrete and Timber



Path Markers T-Series Concrete and Timber

1. Preparation of Surface

- Thoroughly clean the surface with industrial strength cleaner if necessary.
- Remove any loose paint or sealant and then allow surface to dry.
- If painted or coated check that the adhesive is compatible with the paint or seal coating*. IF IN DOUBT REMOVE COATING.

Note: Installation onto Concrete Surfaces

It is important to use adhesive only for concrete installations. The adhesive will allow some movement to compensate for thermal contraction and expansion and will provide durable adhesion to the concrete substrate.

** Where adhesive only installation is preferred on surfaces that have a sealer applied (eg exposed aggregate and some tiles) a test patch should be laid and allowed to temperature cycle over a minimum of 14 days to ensure a good bond is achieved. If the adhesive does not hold then mechanical fixers should be used. If mechanical fixing is not practical due to potential damage to the substrate please contact Ecoglo.*

2. Alignment of the Path Markers

- Mark the position where the path marker is to be placed using a chalk line if necessary to ensure the line is straight.

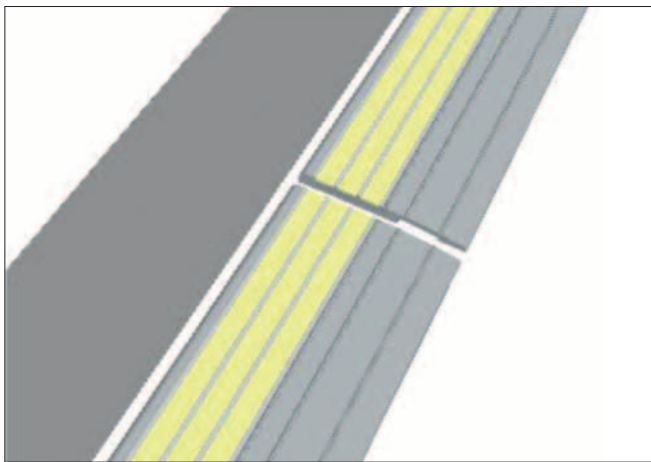

Note: The Path Markers come in 1m lengths. A 3mm expansion/drainage gap must be left between lengths. Markers can be cut with a hand-saw or drop-saw to suit.

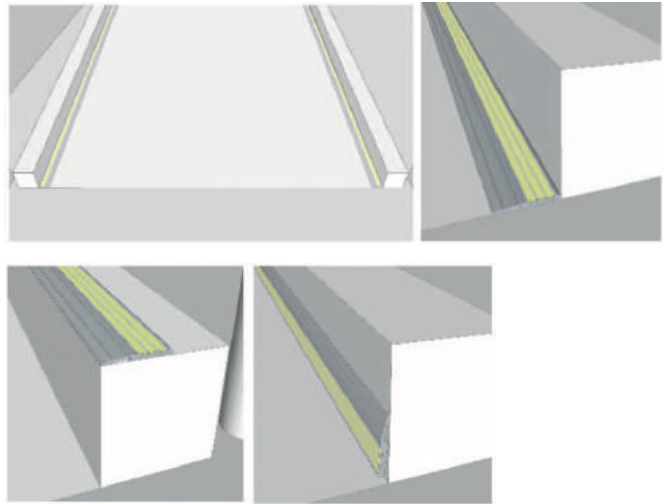

The Path Marker installed in various positions on a ramp.

3. Timber Installation

- Place the path marker in position, lining it up with any markings.
- Pre-drill a pilot hole in the timber if necessary.
- Tighten the screws firmly using a battery drill.

4. Concrete Installation

- Lay a 3mm bead of polyurethane adhesive (either Wurth KD Bond and Seal or Bostik Seal n Flex FC) in a wave pattern over the full length of widest part on the underside of the marker.
- Place the path marker firmly onto the substrate ensuring it is straight.

Adhesive Usage:

T5-101 - 25 metres per 600ml

T6-101 – 30 metres per 600ml

Ecoglo can supply Wurth KD Bond and Seal in 600ml Sausage form with Applicator Gun.

5. Curing of Adhesive

- Use an alcohol wipe to remove any spillover of adhesive.
- Allow approximately 24 hours for adhesive to cure.

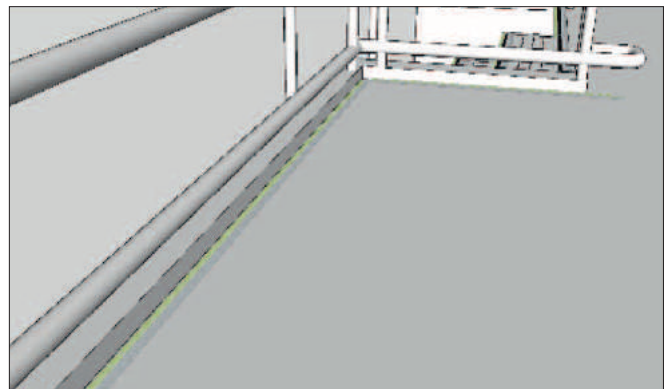

The Path Marker installed adjacent to wall.



Installation Instructions For

Path Marker G7 Solaris

Ecoglo markers are to be installed only where there will be sufficient natural or artificial light to keep them charged whenever the building is occupied.

If unsure, contact Ecoglo



Path Marker G7 Solaris

1. Mounting Location

G7 Solaris Path Markers can be applied to various surfaces including vinyl, concrete and asphalt. Generally, as long as the substrate is clean, flat and dry the product can be successfully installed. However, it is also important that the appropriate fixing method is used.

Ecoglo recommends the following:

- Vinyl surface – pre-fitted release tape
- Concrete surface – adhesive **and** fixers (screws)*
- Asphalt – adhesive **and** fixers (screws), or tar

**If path markers are to be installed in a 'light-duty' area, ie, with foot traffic only, then adhesive only is an option. If the adhesive does not hold then fixers should also be used.*

If in doubt about which method to use please consult Ecoglo.



2. Preparation of Surface

- Thoroughly clean the surface with industrial strength cleaner if necessary.
- Remove any loose paint, sealant or other debris and allow the surface to dry.

- If using adhesive and the surface has been painted or coated, check that adhesive is compatible with the paint or seal coating. **IF IN DOUBT REMOVE COATING.**

3. Positioning and Alignment of Path Markers

- Painted yellow hatch lines are always required when G7 Solaris Path Markers are installed in a building unless there is good reason to be confident that the marked escape route will not get obstructed at any time during occupation of the building. Ecoglo recommends that these lines are painted prior to installation of the path markers so that when lines need re painting the markers aren't in the way.

Note: The yellow painted path must be no less than 850mm wide.

- Refer to the Ecoglo design for spacing details of the G7 Solaris Path Markers.
- Mark the position where the path marker is to be placed using a chalk line if necessary to ensure the line, where appropriate, is straight.



G7 Solaris Path Markers placed on outside of painted path

4. Installation of Path Markers

Pre-fitted release tape

- Remove tape backing strip and line path marker up with your alignment marks.
- Press the path marker firmly in place to ensure even contact between the marker and the surface to which it is being applied.
- Apply even pressure to the marker to ensure it is fixed firmly to the surface.

Path Marker G7 Solaris

Adhesive

- Apply a 3mm bead of polyurethane adhesive (such as Würth KD Bond and Seal or Bostik Seal n Flex FC) in a wave pattern along the full length of the back of the path marker, keeping 3mm in from the edges.
- Line up path marker with your alignment marks.
- Press the path marker firmly in place to ensure even contact between the marker and the surface to which it is being applied.
- Apply even pressure to spread the adhesive beneath the marker using a hand roller.
- Use an alcohol wipe to remove any spillover adhesive.
- Allow approximately 24 hours for adhesive to cure.

Adhesive Usage: 250 pieces per 600ml

Ecoglo can supply Würth KD Bond and Seal in 600ml Sausage form with Applicator Gun.

Adhesive and Fixers (screws)

- Line up path marker with your alignment marks.
- Mark the location of the drill holes with a drill.
- Using a 6mm masonry bit, and a concrete drill, drill the hole that will house the plastic anchor.
- Wipe away any dust or debris.
- Place the plastic anchor fully into the holes.
- Lay a 3mm bead of polyurethane adhesive (such as Würth KD Bond and Seal or Bostik Seal n Flex FC) in a wave pattern over the full length of the underside of the path marker.
- Place the path marker firmly back into place, lining up the drill holes.
- Keep the adhesive clear of the outside edge and the drill holes.
- Insert fixers (screws) and tighten using drill.
- Use an alcohol wipe to remove any spillover of adhesive.
- Allow approximately 24 hours for adhesive to cure.

Adhesive Usage: 250 pieces per 600ml

Ecoglo supply fixers and can also supply Würth KD Bond and Seal in 600ml Sausage form with Applicator Gun.



Installation Instructions For

Aisle Markers Seat Markers

Ecoglo markers are to be installed only where there will be sufficient natural or artificial light to keep them charged whenever the building is occupied.

If unsure, contact Ecoglo



Aisle Markers

Preparation of Surface

- Thoroughly clean the surface with industrial strength cleaner if necessary.
- Remove any loose paint or sealant and then allow surface to dry.
- If painted or coated check that the adhesive is compatible with the paint or seal coating*. **IF IN DOUBT REMOVE COATING.**

**Adhesive only installation is preferred on most concrete surfaces but those that are painted or have a sealer applied (eg exposed aggregate and some tiles) require a test patch to be laid and allowed to temperature cycle over a minimum of 14 days to ensure a good bond is achieved.*

If the adhesive does not hold then mechanical fixers should be used. Ecoglo can supply markers with holes pre-punched in each corner. Alternatively the material can be drilled on site with a standard drill bit but care needs to be taken near the edges to prevent cracking the material. If mechanical fixing is not practical due to potential damage to the marker or the substrate please contact Ecoglo.

Placement of Standalone Aisle Markers

- Maintain a consistent positioning for each marker.
- Ensure marker is placed as far from foot traffic as practical while still remaining visible to moving patrons.

Fitting Aisle Markers to Nosings

- If the aisle markers are being fitted into the ends of a step nosing then additional planning is required. The best option is to install the markers prior to fitting the insert strip. There may be a small size variation between each aisle marker so, by installing them first, the insert strip can be accurately measured to the correct size for a clean finish.

Installation

- Lay a 3mm bead of polyurethane adhesive (either Wurth KD Bond and Seal or Bostik Seal n Flex FC) in a wave pattern over the full length of widest part on the underside of the marker.
- Place the path marker firmly onto the substrate ensuring it is straight.

Adhesive Usage:

SQ63 - 350 markers per 600ml

SQ90 - 250 markers per 600ml

Ecoglo can supply Wurth KD Bond and Seal in 600ml Sausage form with Applicator Gun.

Curing of Adhesive

- Use an alcohol wipe to remove any excess adhesive that may have squeezed out.
- Allow approximately 24 hours for adhesive to cure.

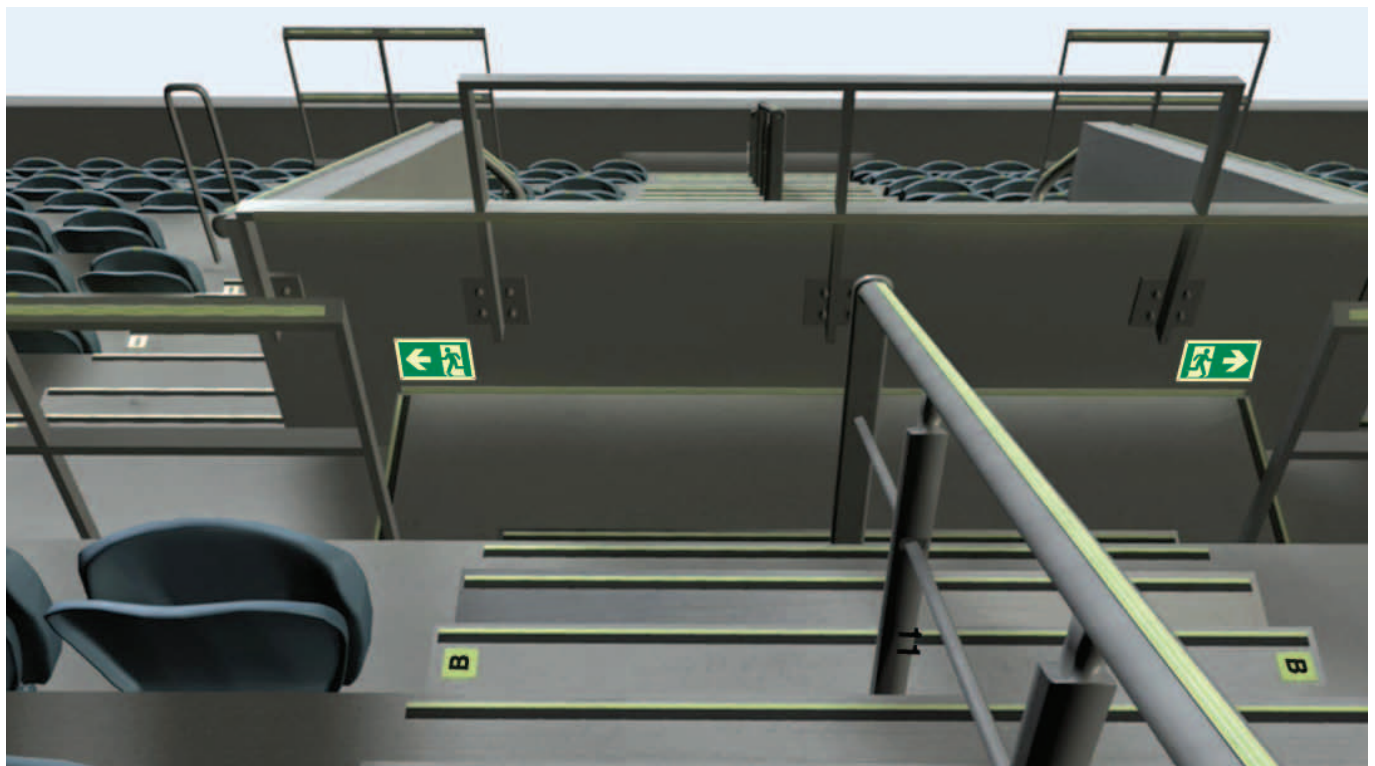
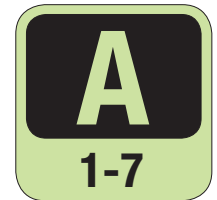
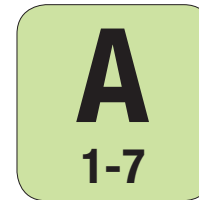
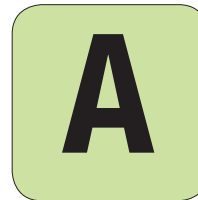

Seat Markers

Preparation of Surface

- Thoroughly clean the surface with industrial strength cleaner if necessary.
- Remove any loose paint or sealant and then allow surface to dry.
- Check that the adhesive is compatible with the seat material prior to starting the installation*.

**Standard installation requires rivets only. Most markers are drilled with a 3.0mm hole on two ends for 2.4mm rivets. If drilling into the seat is not practical then the markers can be fixed with adhesive only. A test piece should be adhered and allowed to temperature cycle over a minimum of 14 days to ensure a good bond is achieved. If the adhesive does not hold then mechanical fixers should be used.*

Placement of the Seat Markers

- Maintain a consistent positioning for each marker.
- Ensure that marker can be clearly seen when the seat is unoccupied.
- Most seating has a moulded recess to hold a marker. Ecoglo have common sizes of marker available to suit a variety of manufacturer's seating. Contact Ecoglo for more information.



Installation with Rivets

- Where rivets are being used to fix the marker, the holes should be predrilled.
- On smaller projects these can be marked manually with a vivid pen for each marker.
- On larger projects, a jig can be fabricated to fit the seat which will speed up the marking process.

Rivets: Aluminium domed 2.4mm x 5.8mm.

Installation with Adhesive

- Each marker only requires two 5mm dots of adhesive.
- Once placed on the seat masking tape should be used to hold the marker in position until the adhesive cures.
- Use an alcohol wipe to remove any excess adhesive.
- Allow approximately 24 hours for adhesive to cure.

Ecoglo can supply Wurth KD Bond and Seal in 600ml Sausage form with Applicator Gun.

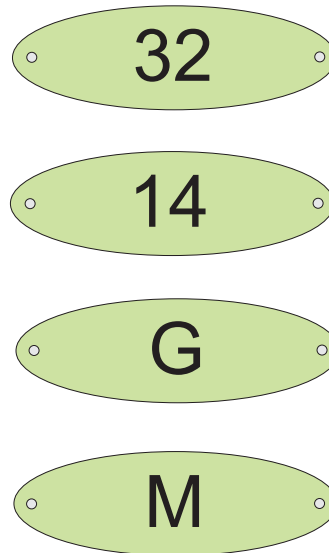

A Guide To

Marking Different Door Types

Single Swing Doors

Double Doors

Commercial Sliding Doors



A Guide to Marking Different Door Types

Single Swing Door

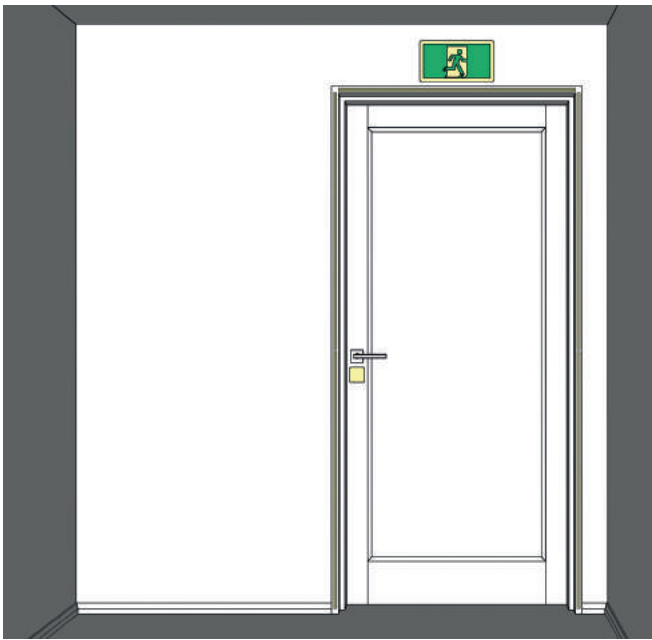

View of the G3-001T door frame markings, SQ60 door handle marker, and S20 exit sign.

Double Door

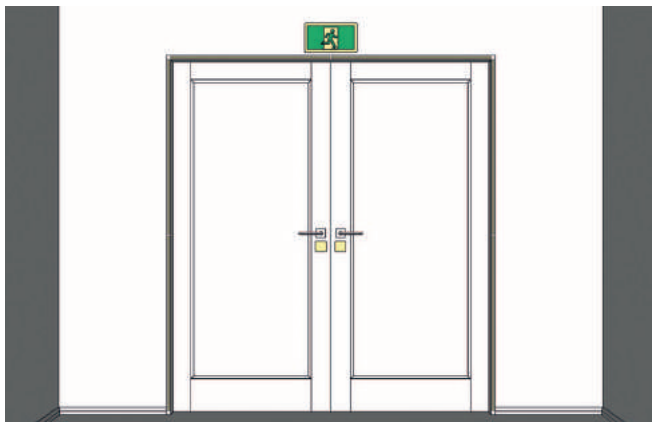

View of the G3-001T strips around the door frame, SQ60 door handle markers, and S20 exit sign.

Commercial Sliding Doors

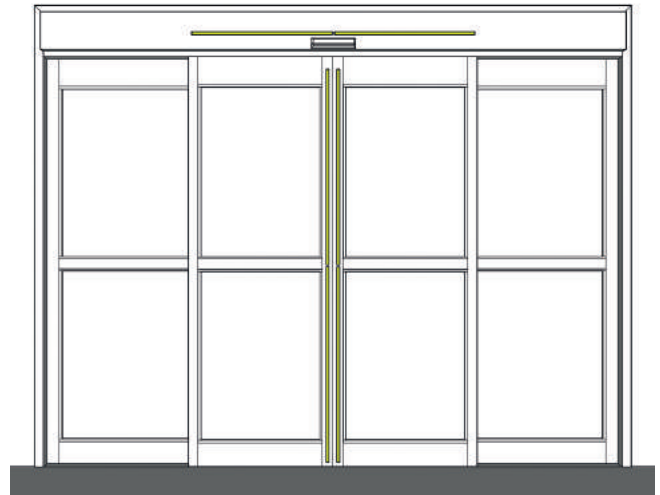

View of G3-001T strips when installed to mark the frame of a closed automatic sliding door.

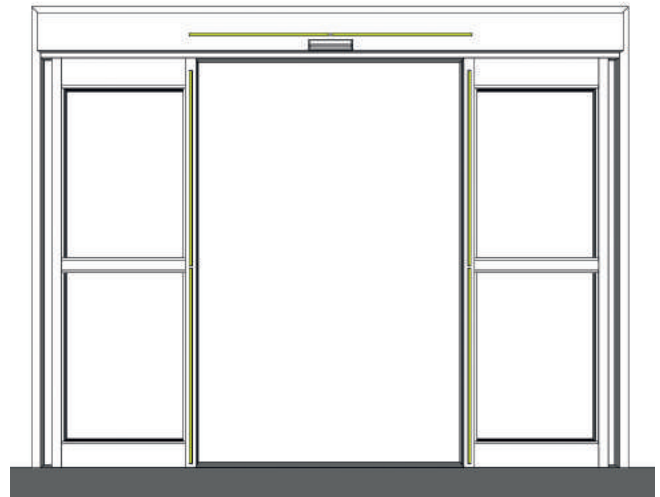

View when automatic sliding door is open.

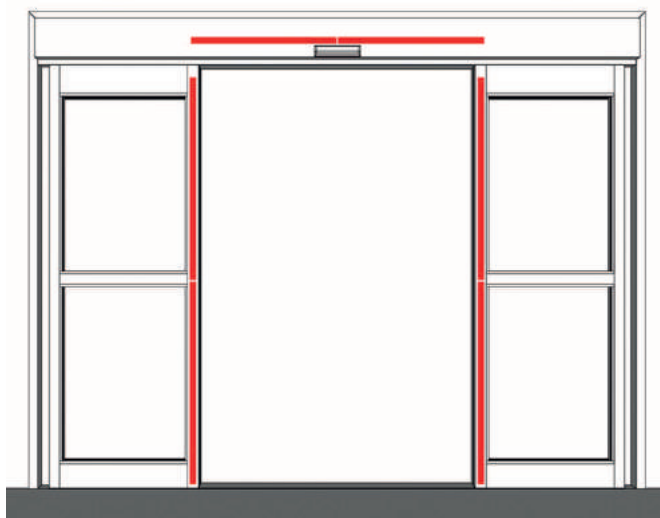

When the door is used in an emergency, the strips form a framed doorway to guide occupants through.

Instructions For

Cleaning

Exit Signs and Escape Path Markings

Ecoglo Australia
Email: info@ecoglo.com
Ph: +61 3 8691 5288
www.ecoglo.com.au

Ecoglo New Zealand
Email: info@ecoglo.com
Ph: +64 3 348 3781
www.ecoglo.co.nz



Cleaning Instructions

For Exit Signs and Escape Path Markings

Overview

- Regular maintenance and cleaning to remove any obstructions or built up dirt and deposits will ensure the Ecoglo products continue performing to expectation.
- The photoluminescence will continue performing even after UV exposure or exposure to moisture.

Floor Mounted Products

- Check nothing is covering up the product.
- Visually inspect for any sign of damage.
- Vacuuming or brushing with a stiff bristle head brush (dry or wet) is often enough to keep the strips clean.
- The glowing strip can also be wiped clean with a (dry or wet) sponge or cloth.
- High-pressure water (but not steam cleaning) can also be used.
- Observation will determine if cleaning is required however a regular clean every 4 to 6 weeks or after particularly heavy use should ensure correct performance.

Wall Mounted Products

- Check nothing is covering up the sign.
- Visually inspect for any sign of damage.
- Dusting with a soft cloth or brush is often enough to keep the signs clean.
- The glowing material can also be wiped clean with a (dry or wet) sponge or cloth.
- Observation will determine if cleaning is required.

Note

- Do not use highly alkaline or acidic cleaning agents. The pH of the cleaning agents should be between pH 5 and pH 12.
- If cleaning agents are applied at more than pH 10, the Ecoglo material should be rinsed with pH neutral (pH 6 to pH 8) solution afterwards.



Installation Instructions For
Hybrid Signs

See [website](#)

